

SAKWRX 3D Print Remover
ASSEMBLY INSTRUCTIONS
STL File Scaling

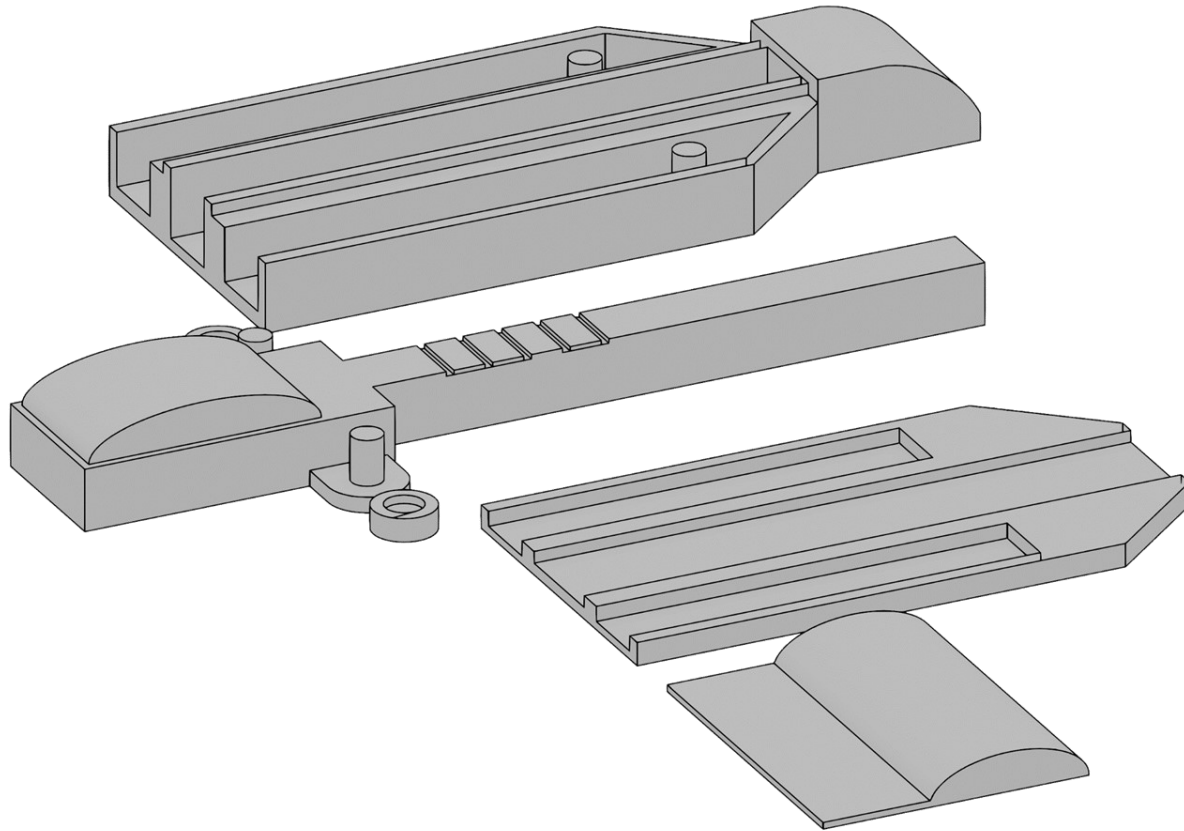

SAKWRX 3D Print Remover

ASSEMBLY INSTRUCTIONS

STL File Scaling

When importing your .STL model files into a 3D slicer program (Cura, Creality Print, etc.), first ensure the "Hammer" part is 119mm on the longest side. Scale uniformly, as needed.

Use the resulting scale percentage to uniformly scale the remaining parts before slicing.

SAKWRX 3D Print Remover

ASSEMBLY INSTRUCTIONS

STL File Scaling

